



**INSTALLER/CONSUMER RETAIN THIS APPLIANCE  
MANUAL WITH THE INSTALLED APPLIANCE**



F23-213

## INSTALLATION AND OPERATING INSTRUCTIONS

GOLDEN BLOUNT

**MODEL OD-LFP7218**



**FOR NATURAL GAS ONLY**



**IMPORTANT! Read all instructions carefully before starting installation. Failure to follow these instructions may result in property damage, personal injury or possible loss of life.**

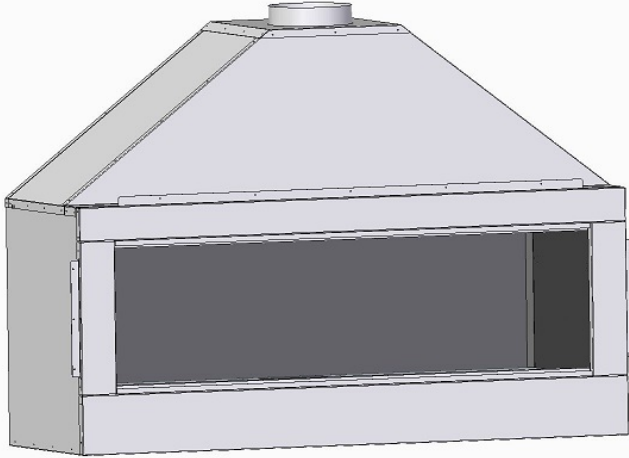

### **WARNING**

#### **FOR OUTDOOR USE ONLY.**

Installation and service must be performed by a qualified installer, service agency, or the gas supplier.

### **DANGER**

#### **IF YOU SMELL GAS:**

- Shut off gas to the appliance.
- Extinguish any open flame.
- If odor continues, leave the area immediately.
- After leaving the area, call your gas supplier or fire department.

Failure to follow these instructions could result in fire or explosion, which could cause property damage, personal injury or death.

### **WARNING**

Do not store or use gasoline, or other flammable vapors and liquids, in the vicinity of this or any other appliance.

## **DANGER**



#### **CARBON MONOXIDE HAZARD**

This appliance can produce carbon monoxide which has no odor.

Using it in an enclosed space can kill you. Never use this appliance in an enclosed space such as a camper, tent, car or home.

MANUFACTURED BY:

*Golden Blount*

4301 WESTGROVE DRIVE  
ADDISON TX. 75001

### **WARNING**

Improper installation, adjustment, alteration, service or maintenance can cause injury or property damage. Read the installation, operating and maintenance instructions thoroughly before installing or servicing this equipment.

## TABLE OF CONTENTS

### **Section**

Table Of Contents .....	2
Important Safety Information .....	3
Product Specifications .....	4
Accessories .....	4
Introduction .....	5
Combustible Materials .....	6
Clearances .....	6
Fireplace / Framing Dimensions .....	7
Planning Installation .....	8-9
Installing Chimney / Vent System .....	10
Connecting The Gas Line .....	11
Media/Glass Wind Guard Installation.....	12-13
Lighting Instructions .....	14
Operating Guide lines .....	15
Maintenance Instructions .....	15
Parts .....	15
Warranty .....	16

# IMPORTANT SAFETY INFORMATION

**⚠ DANGER:** Indicates a hazardous situation which, if not avoided, will result in death or serious injury.

**⚠ WARNING:** Indicates a hazardous situation which, if not avoided, could result in death or serious injury.

**⚠ CAUTION:** Indicates a hazardous situation which, if not avoided, could result in minor or moderate injury.

**NOTICE:** Addresses practices not related to personal injury.

## **⚠ WARNING**

Do not place debris, logs, or other articles in fireplace during operation.

## **⚠ WARNING**

Any modification to controls can be dangerous. Improper installation or use of the gas log set can cause serious injury or death from fire, burns, explosion or carbon monoxide poisoning.

## **⚠ WARNING**

Make a periodic visual check of burners. Clean and replace damaged parts.

## **⚠ DANGER**

Children and adults should be alerted to the hazard of high surface temperature and should stay away to avoid burns or clothing ignition.

## **⚠ DANGER**

Young children should be carefully supervised when they are in the same area with the fireplace.

## **⚠ DANGER**

Clothing or other flammable materials should not be hung from the fireplace, or placed on or near the fireplace.

## **⚠ DANGER**

Keep the fireplace area clear and free from combustible material, gasoline and other flammable vapors and liquids.

- **Installer:** Please leave these instructions with the owner for future reference
- This unit complies with ANSI Z21.97/CSA 2.41 for Outdoor Gas Fireplaces.
- Installation and repair should be done by a **QUALIFIED SERVICE PERSON**. This fireplace should be inspected before use and at least annually by a professional service person. More frequent cleaning may be required due to insects, pollen build up, dust, etc. It is imperative that the control compartments, burners, and circulating air passageways of the fireplace be kept clean.
- During manufacturing, fabricating and shipping, various components of this fireplace are treated with certain oils, films or bonding agents. These agents are not harmful, but may produce annoying smoke and smells as they are burned off during initial operation of the fireplace. This is a normal temporary occurrence.
- Follow all local codes regarding installation, combustion and ventilation air or in the absence of local codes follow the National Fuel Gas Code ANSI Z223.1 (US installation).
- Inspect the burner at least once a year.
- Keep burner and control compartment clean.
- **DO NOT** use this fireplace if any part has been under water. Immediately call a qualified service technician to inspect the fireplace and to replace any part of the control system and any gas control which has been under water.
- Any guard or other protective device removed for servicing the appliance must be replaced prior to operating the appliance.

## PRODUCT SPECIFICATIONS

GAS SUPPLY PRESSURES (INCHES WATER COLUMN)			
		Maximum	Minimum
<b>Gas Type</b>	Natural	8	6

<b>Model Number</b>	<b>LFP-7218-N/G</b>			
Input BTU/Hr Maximum	65,000			
Input BTU/Hr Minimum	N/A			
Orifice	#30			
Air Shutter Setting	1/4" Open			
Gas Inlet Shut-Off Valve Pipe	1/2 NPT			

## ACCESSORIES

### MODEL

**LFP-AL-GS** (6 Piece Accent Logs Gulf Shores)  
**LFP-RRC-STONES** (25 Piece Red Rock Canyon Stones)  
**GHOSTWOOD** (3 Piece Log Accent Kit - photo below)  
**LFP-7218-GLASS** (Rear Decorative Glass Panel)  
**FLT-BRICK-LFP** (Fluted End Panels) (Specify Color)

Using small Granular Lava Rock or approved Granular Fire Glass floor media is recommended. Covering the floor area creates a more appealing interior Firebox and quieter Burner Operation.

See your Dealer for information and availability of all Accessories, or call Golden Blount, LLC 1-800-833-1139.

# INTRODUCTION

## Instructions to Installer

1. Installer must leave instruction manual with owner after installation.
2. Installer should show owner how to start and operate outdoor fireplace.

Always consult your local Building Department regarding regulations, codes or ordinances which apply to the installation of an outdoor gas fireplace.

### WARNING

**To avoid injury or damage to the fireplace or surrounding area, do not burn wood or other solid fuels in this fireplace.**

### WARNING

**ANY CHANGE TO THIS FIREPLACE OR ITS CONTROLS CAN BE DANGEROUS.**  
**Improper installation or use of the fireplace can cause serious injury or death from fire, burns, explosion or carbon monoxide poisoning.**

This Fireplace is design certified in accordance with **ANSI Z21.97 for Outdoor Gas Fireplaces** and should be installed according to these instructions.

**Any alteration of the original design, installing it other than as shown in these instructions or using a type of gas not shown on the rating plate, is the responsibility of the person and company making the change.**

## Important

All correspondence should refer to complete Model Number, Serial Number and type of gas.

## Moisture Resistance

This outdoor fireplace will shed moderate amounts of water, but is not waterproof. Water and condensing water vapor may enter the chase under certain conditions.

The fireplace will not perform as an exterior wall. Moisture penetration must be considered for construction that places the fireplace in structure walls or on moisture sensitive surfaces.

When installed through exterior walls: Golden Blount LLC recommends the fireplace chase be constructed outside the structure's weather envelope. Where the platform meets the wall, use a flashing detail similar to that required for attached decks. Chase platforms, including hearths should slope away from the structure at 1/4 in. per foot. The fireplace can be shimmed level.

When installed on surfaces where water may collect or cause damage: Golden Blount LLC recommends a slope of 1/8 to 1/4 in. per foot towards the drain port suggested. The fireplace can be shimmed level.

## Qualified Installing Agency

Installation and replacement of gas piping, gas utilization equipment or accessories and repair and servicing of equipment shall be performed only by a qualified agency. The term "qualified agency" means any individual, firm, corporation or company which either in person or through a representative is engaged in and is responsible for (a) the installation or replacement of gas piping or (b) the connection, installation, repair or servicing of equipment, who is experienced in such work, familiar with all precautions required and has complied with all the requirements of the authority having jurisdiction.

## Local Codes

- When the fireplace is connected to a fixed piping system, the installation must conform with local codes, or in the absence of local codes with the *National Fuel Gas Code, ANSI Z223.1/NFPA 54*, or *International Fuel Gas Code*.

Commonwealth of Massachusetts: The installation must be made by a licensed plumber or gas fitter in the Commonwealth of Massachusetts.

The installation must conform with local codes or, in the absence of local codes, with the National Fuel Gas Code, ANSI Z223.1.\*

*\*Available from the American National Standards Institute, Inc. 1430 Broadway, New York, N.Y. 10018.*

## High Altitudes

For altitudes/elevations above 2,000 feet (610m), ratings should be reduced at the rate of 4 percent for each 1,000 feet (305m) above sea level. Contact the manufacturer or your gas company before changing spud/orifice size.

# COMBUSTIBLE MATERIALS

Do not attach combustible material to the mantel of your fireplace. This is a fire hazard.

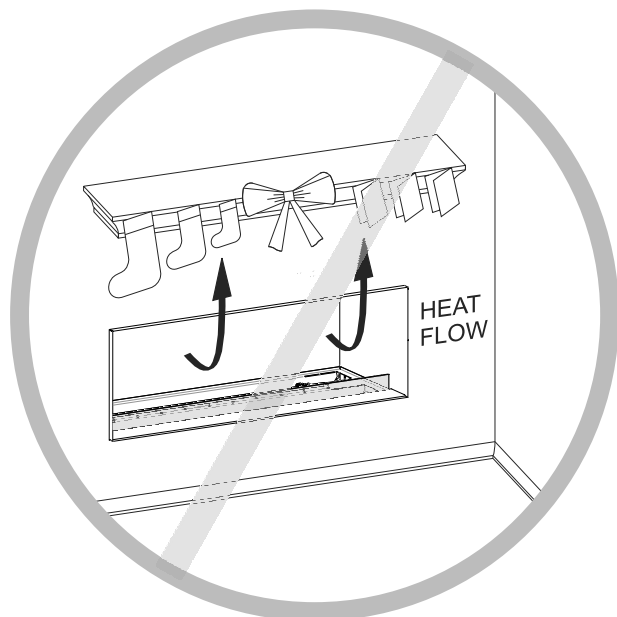

Figure 1

No greeting cards, stockings or ornamentation of any type should be placed on or attached to the fireplace. This is a heating appliance. The flow of heat can ignite combustibles.

## Television Considerations

Installing a television above a fireplace has become increasingly popular; however, the area above any fireplace gets hot and most TV manufacturers recommend against placing their products near a heat source.

If you install a television above this fireplace, we accept no responsibility for damage or injuries. Follow the television manufacturer's installation instructions, including any recommendations regarding proximity to heat sources. If you have a TV above your fireplace, turn off the fireplace and let it cool completely before servicing or touching any buttons on the TV.

# CLEARANCES

## Minimum Wall and Ceiling Clearances

**Sidewall Clearances:** The clearance from the inside of the fireplace

to any combustible wall should not be less than 5 1/2 in. **Ceiling**

**Clearances:** The ceiling height should not be less than 24 in. from the top opening.

**Mantel Clearances:** If a combustible mantel is installed, it must meet the clearance requirements detailed in **Figure 2**.

Maintain minimum 1/2" clearance to back and sides of the Fireplace

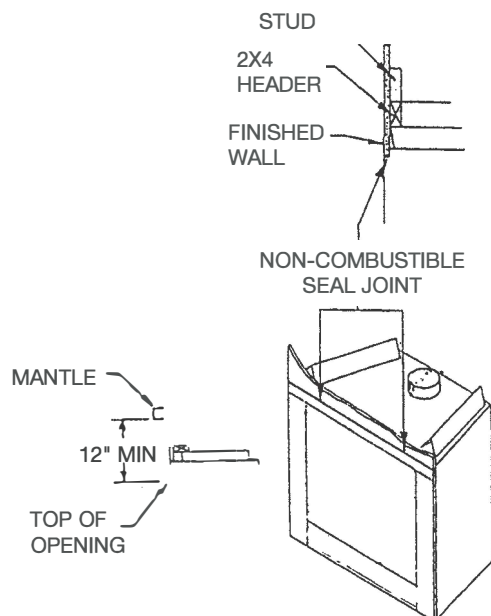
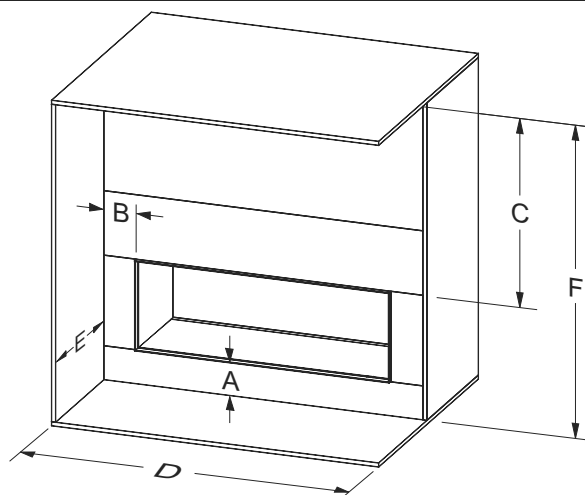

Figure 2 - Mantel Clearances



Index Letter	Description	Dimension from Fireplace Opening (in inches)
A	From ground or other combustible surface	7
B	From Side Walls	5.5
C	From Ceiling (minimum)	24
D	Alcove Width (minimum)	83
E	Alcove Depth (maximum)	24
F	Ceiling Height (minimum)	90

Figure 3 - Alcove Clearances

## MINIMUM FRAMING DIMENSIONS OD-LFP7218

### OD-LFP7218 LINEAR TOP VENT ROUGH FRAMING DIMENSIONS

MINIMUM FRAMING DIMENSIONS PRIOR TO POSITIONING UNIT

LFP7218 87"W X 52"H X 24" D

FINISHED FRAMING DIMENSIONS WITH UNIT IN POSITION

LFP7218 82"W X 32"H X 24"D

NOTE: DIMENSIONS PRIOR TO POSITIONING FIREPLACE ALLOWS CLEARANCE FOR OUTSIDE AIR COLLARS AS WELL AS FIREPLACE HEADER TO BE NAILED AT CORRECT HEIGHT AFTER BOX HAS BEEN SET.

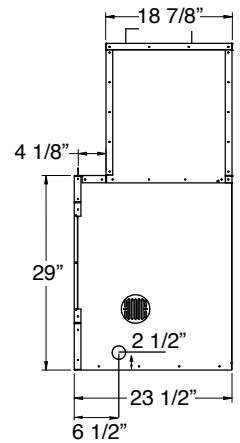
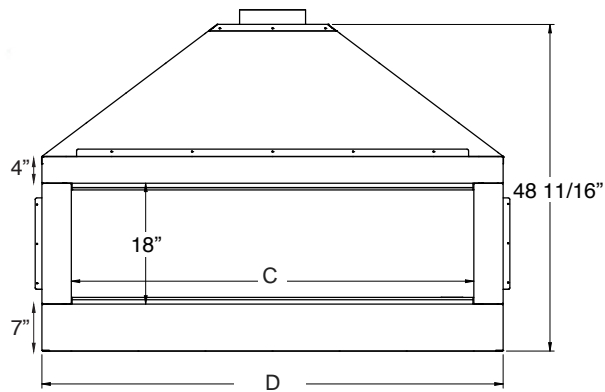
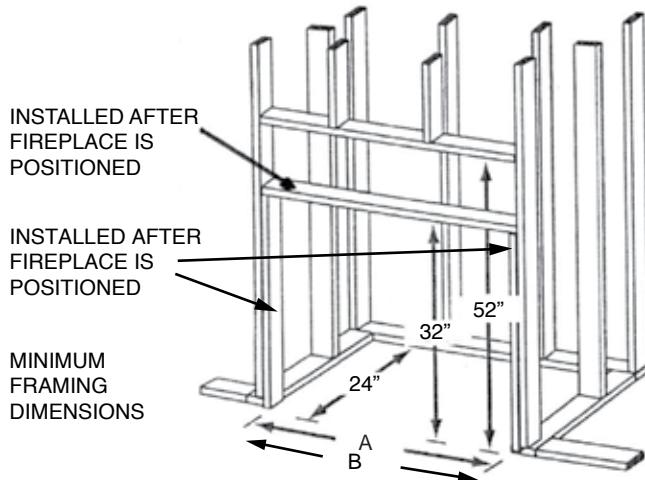
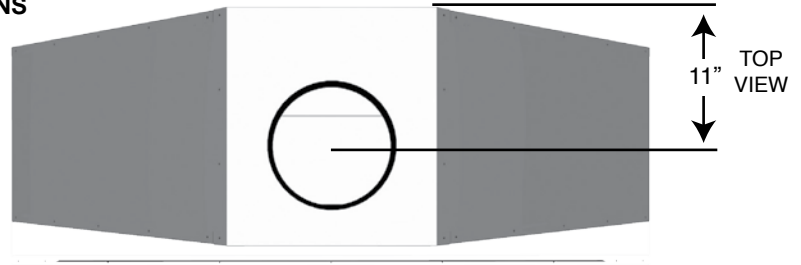

**OD-LFP7218**

**A 82"**

**B 87"**

**C 72"**

**D 80 3/4"**

# PLANNING INSTALLATION

## What to Consider Before Installing

1. Verify fireplace gas type and gas supply type are the same.
2. Look for a location where combustibles will not interfere.
3. Choose a location for gas control valve.
4. Verify ventilation meets at least minimum requirements
5. Drainage under fireplace.

When planning the installation for the fireplace, determine where the unit is to be installed. Gas supply piping should also be planned at this time.

The fireplace can be mounted on any of these surfaces:

1. A raised frame of combustible material so contact is made on all four perimeter edges of the bottom of the fireplace at least 3-1/2 in. above the floor.
2. Four corners of the fireplace so contact is made on all four perimeter edges on the bottom of the unit at least 3-1/2 in. above the floor. Check local codes for allowances.

At this point, you should have decided what components to include in your installation, and where the fireplace is to be located. If this has not been done, stop and consult your dealer for assistance with this planning.

### WARNING

**This fireplace is intended for installation on an outdoor patio or yard. This fireplace shall be used only outdoors in a well ventilated space and shall NOT be used in a building, garage, or other enclosed area. This fireplace cannot be installed with an opening to the inside of a residence.**

**NOTICE:** This fireplace is NOT equipped with an Oxygen Depletion Sensor (ODS) pilot.

Installation of the fireplace may be in an "open" area, however it is recommended that this fireplace be installed in an area sheltered from direct winds. Direct wind will cause an erratic flame and possible burner outage. This erratic flame could also lead to excessive black soot. These are nuisance issues rather than safety issues. Avoid areas where excessive moisture or running water may be near or on fireplace.

Typical installation may include covered patio, open porch, gazebo or an outside wall of a house.

- Minimum porch area – 96 square feet
- Minimum ceiling height – 90 inches

## Outdoor Fireplace Enclosure Requirements

Do not install fireplace until all necessary provisions are made for combustion and ventilation air. Consult the written instructions provided with the fireplace for information concerning combustion and ventilation air. In the absence of instructions, refer to the National Fuel Gas Code, ANSI Z223.1/ NFPA 54, Air for Combustion and Ventilation, or applicable local codes

Installation in partial enclosures must conform with one of the following conditions:

- With walls on all sides, but with no overhead cover.

**See Figure 1.**

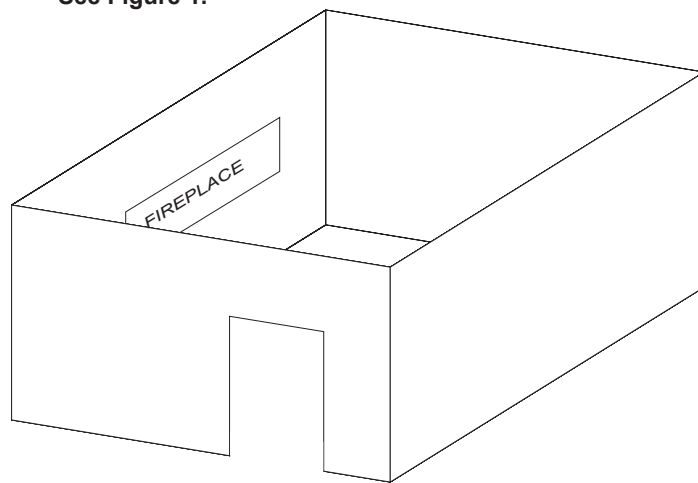

**Figure 1**

- Within a partial enclosure which includes an overhead cover and no more than two side walls. These side walls may be parallel, as in a breezeway or at right angles to each side.
- See Figure 2.**

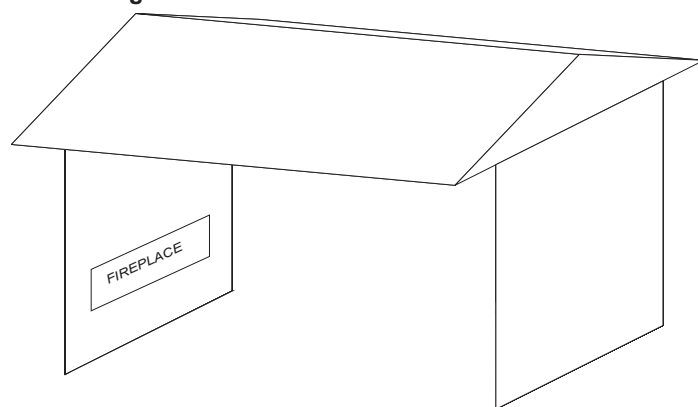

**Figure 2**



## PLANNING INSTALLATION (CONT'D)

- Within a partial enclosure that includes an overhead cover and three side walls, as long as 30 percent or more of the horizontal periphery (perimeter of walls and open side) of the enclosure is permanently open. **See Figure 3.**

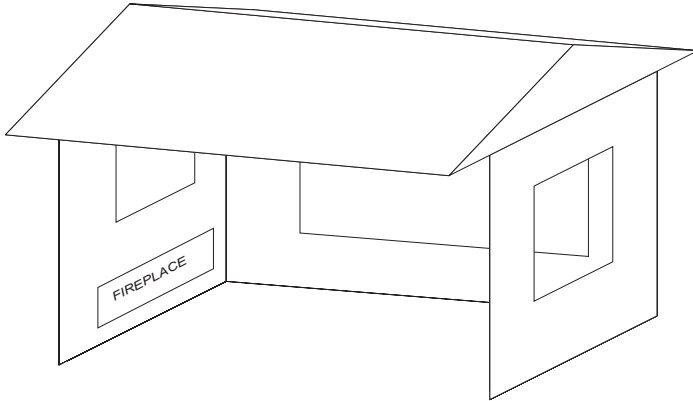

Figure 3

If installing in a screened in porch, the open space must be adjusted (increased) from 30 percent (adjusted open space = 30% / % open area of the screen mesh). "Example, if you used a screen with a 66% open area, the minimum open space of your building must be 46% of the periphery. If you have a covered screened-in porch that has two side walls that are 16', one wall that was against the house that's 20' and one open side that's 20', you would have a perimeter of 72'. You would need to have 33' of the perimeter open ( $72' \times 46\% = 33'$ )."

**(Contact your screen manufacturer or screen dealer to determine your screens open area).**

### **⚠ WARNING**

**Improper installation, adjustment, alteration, service or maintenance can cause property damage, personal injury or loss of life. Installation and service must be performed by a qualified installer, service agency or the gas supplier.**

### **⚠ WARNING**

**Leak test all connections with a soap and water solution. Bubble formation will indicate a leak. Use caution to avoid burns.**

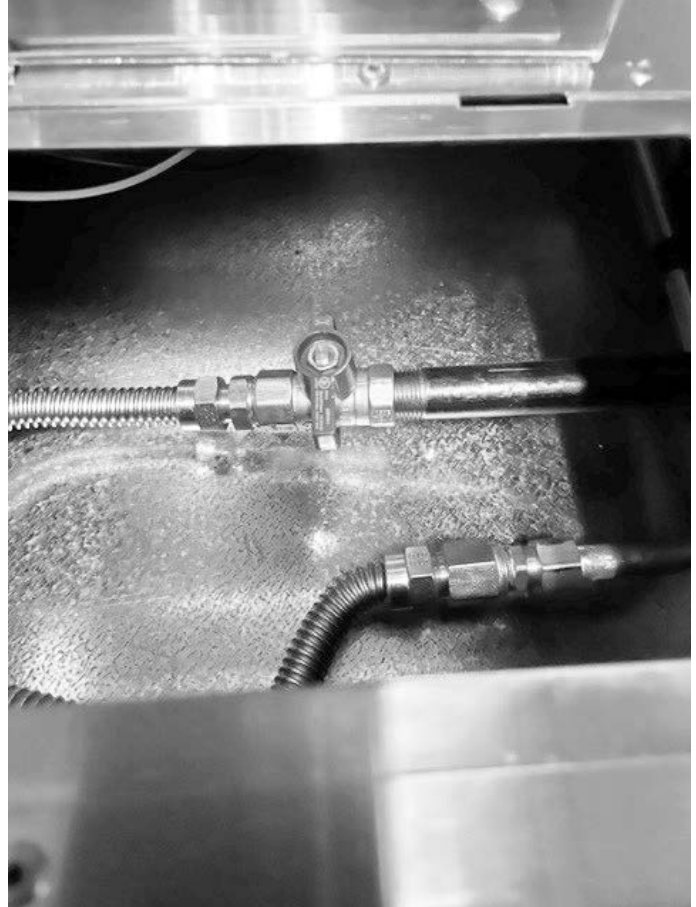

Figure 8

### **Gas Line Connection**

The fireplace is designed to accept a 1/2 in. gas line. Have the line installed by a qualified service person in accordance with all building codes. Consult local building codes to properly size the gas supply line leading to the 1/2 in. hook-up at the unit. The state of Massachusetts requires that a flexible fireplace connector cannot exceed three feet in length.

A flex-line connection to the valve is provided. **The gas key valve, valve must be located outside of the unit in an accessible area.** And within reach of Spark Ignitor Button located in the floor area of fireplace.

## Installing Chimney/Vent System

Model OD-LFP7218 is approved to be used with B-Type Gas Vent. Under most conditions the fireplace system will draw properly if the chimney height is determined in accordance with the following guidelines: **Note: (90-degree elbows are not approved! Maximum offset angle must not exceed 45 degrees.)** Many manufacturers of B-Type gas vent offer “High Performance,” or “High Wind” caps. These caps limit the outlet area for flue gases to expel and should not be used with this fireplace. In the event of draft related problems due to extreme wind conditions, a special wind ring is available.

1. For Free Standing Installations where the fireplace will not penetrate an overhead roof cover, a minimum of 2' of 10" B-Vent chimney is required and a 10" B-Vent Termination Cap installed.
2. For installation where the fireplace will penetrate an overhead roof cover, the 10" B-Vent chimney must clear the roof cover and extend a minimum 2' through the roof cover.

### Finishing the Wall

Finish the wall with the material of your choice. Do not install a combustible mantle or other combustible projection above the fireplace opening unless it is a minimum of 12 inches above top of fireplace opening. (Figure 1)

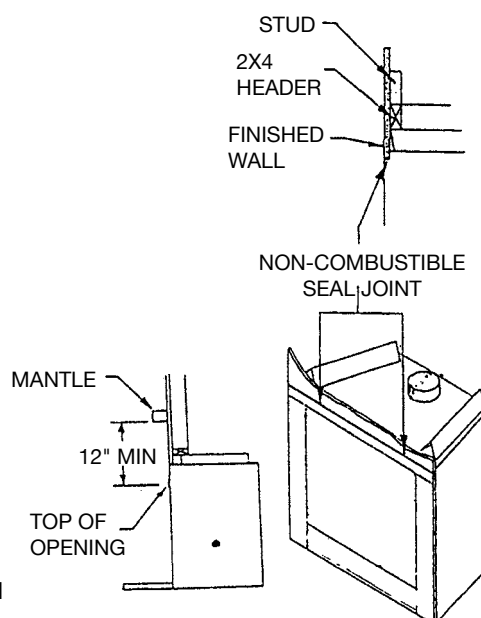

Figure 1

**CAUTION:** All joints between the finished wall and the fireplace surround (Top and Sides) can only be sealed with non-combustible material. Only non-combustible material can be applied as facing to the fireplace surround. (Figure 1)

### Hearth Extension

A Hearth Extension may be installed. But it is not required for vented gas fireplaces.

## Connecting the Gas Line

Consult local building codes before gas line installation....This Fireplace is supplied with a Key Valve that is used to supply Gas to the Fireplace Burner and adjust Burner Flame up and down. There is an additional Gas Shutoff Valve located below the floor of the fireplace accessed through the Valve Access door. The Key Valve is designed to be serviced with a 1/2" NPT. Gas Supply and supplies the Gas to a 1/2" Flare Gas connector. See Figure 1 and 2.

**IMPORTANT:** CHECK ALL GAS CONNECTIONS WITH A LEAK CHECK SOLUTION TO CONFIRM ALL CONNECTIONS ARE SEALED.



Fig. 1 Key valve components.

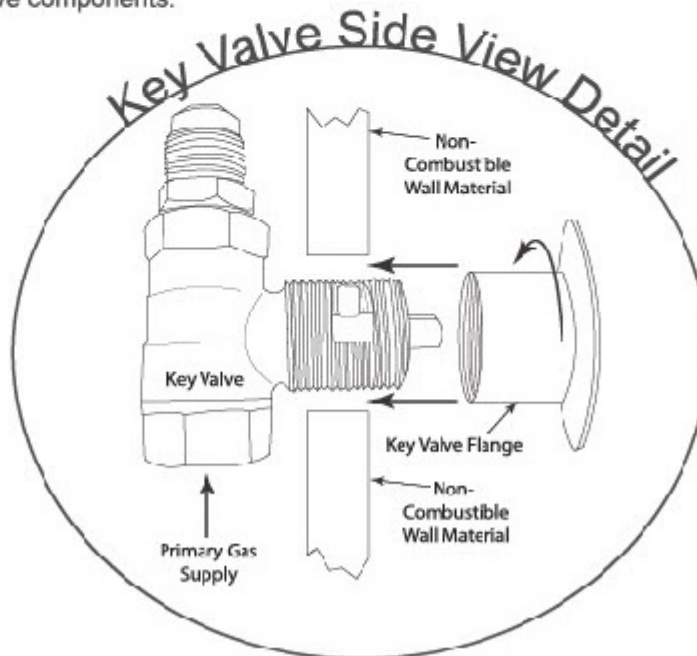

Figure 2

# MEDIA INSTALLATION

1. MODEL OD-LFP7218 can be used with approved Fireglass or Lava Rock to enhance the overall appearance.
2. Fill the burner tray below and up to the top of the burner ports. Do not cover burner ports.
3. Distribute additional material around front, sides and rear of burner tray, covering floor area.

(Figures 1-2)

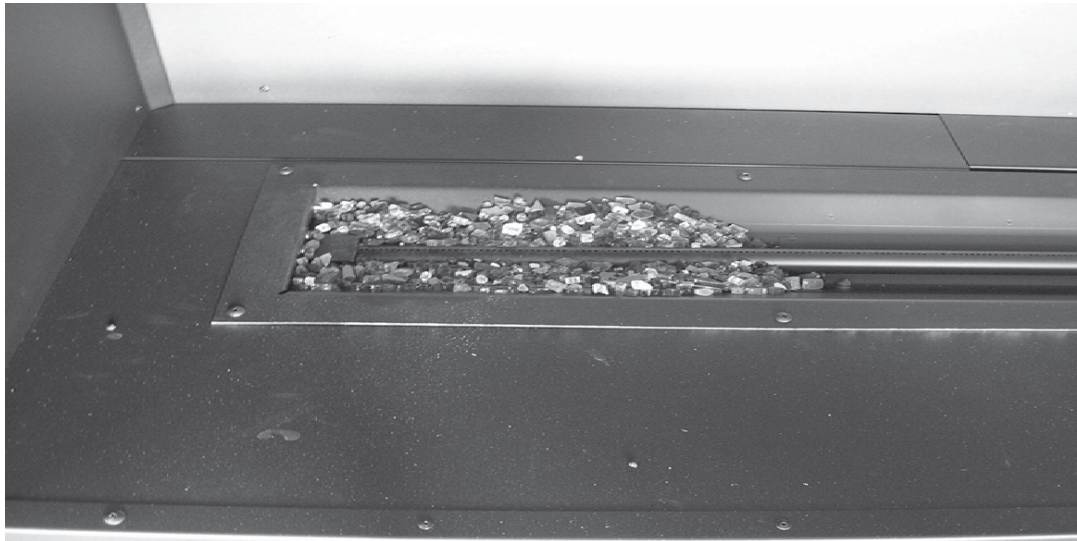

Figure 1



Figure 2

# GLASS WIND GUARD INSTALLATION

1. Model OD-LFP7218 is supplied with a Glass Wind Guard that protects the flame from disruptive winds.
2. Locate the front, left, and right Wind Guard pieces. Left and right returns have assembled brackets that will attach to front piece. See Figure 1. NOTE: Brackets with rubber pad sits on Fireplace floor.
3. While holding front piece upright, position right return next to right side of the front piece and loosen two set screws, so the rubber pad will be flush with bracket inside edge. See Figure 2.

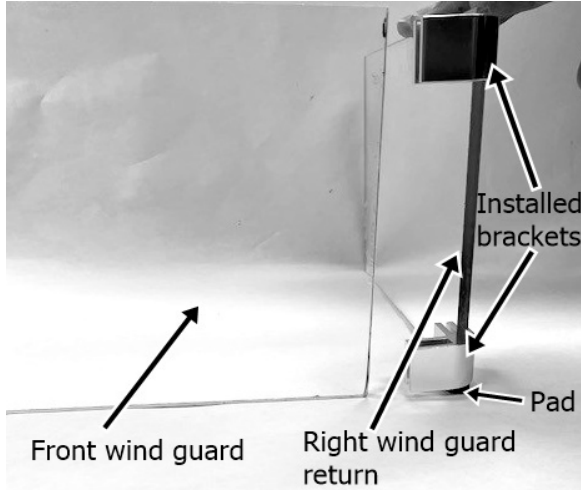

Figure 1

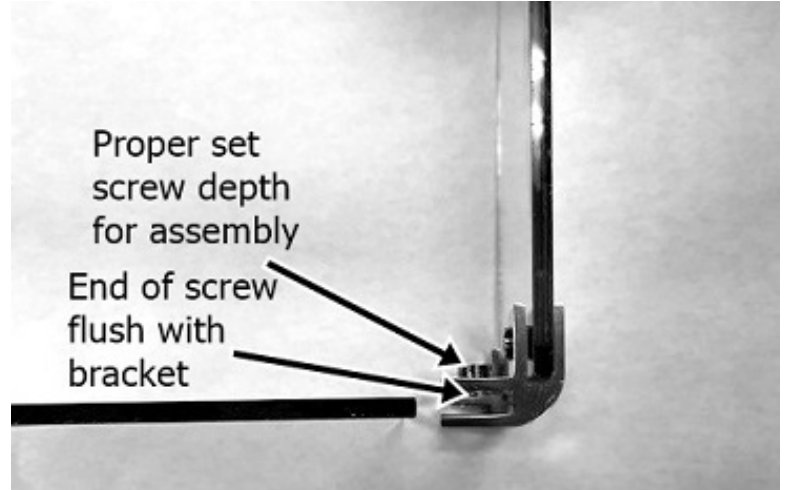

Figure 2

4. Press brackets over edge of glass and tighten two screws. DO NOT OVERTIGHTEN. Figure 3.
5. Repeat Steps 3 and 4 to attach Left return to left side of front glass.
6. After assembling left and right returns, carefully position assembled Wind Guard into Fireplace, placing front piece into two position clips shown in Figure 4.

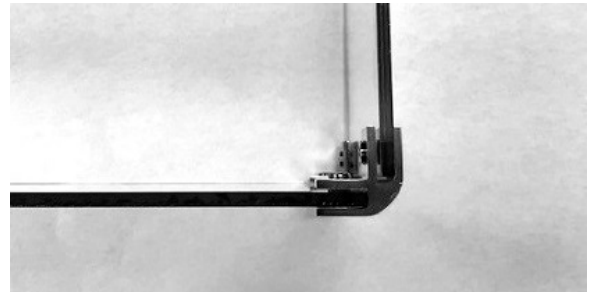

Figure 3

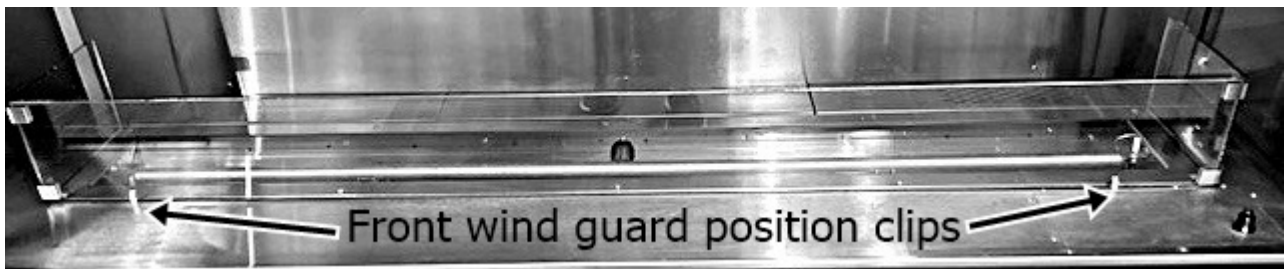

Figure 4

7. Center Wind Guard left to right using Burner Pan Bezel as a reference. Figures 5 & 6.

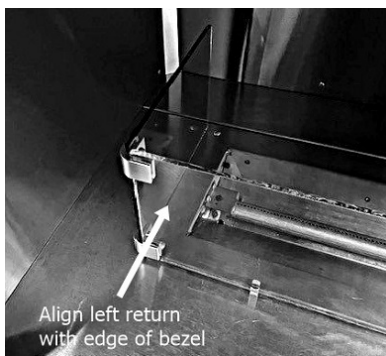

Figure 5



Figure 6



# LIGHTING INSTRUCTIONS

## **READ ALL LIGHTING INSTRUCTIONS BEFORE ATTEMPTING TO LIGHT FIREPLACE**

**CAUTION:** Ensure you have leak tested the Fireplace before operating.

1. Insert key into gas valve.
2. Push and hold the button on the manual Piezo ignitor(Fig 1) and ensure sparking is occurring at the probe inside the Fireplace
3. Rotate the key counter-clockwise in gas valve to allow gas to flow.
4. Gas should ignite within 5 seconds or less. If fireplace does not light within 5 seconds turn key clockwise to turn OFF the gas supply. Check ignitor probe location (Fig. 2), ensure there is an 1/8" gap between the probe with a good strong spark then repeat steps 2 through 4.
5. To turn OFF Fireplace, Rotate the Key Clockwise until it stops.

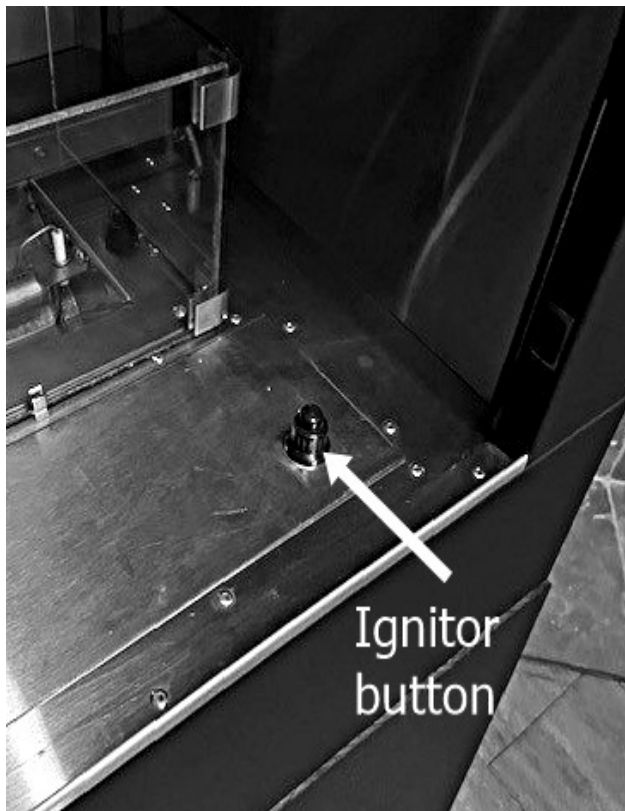

Figure 1

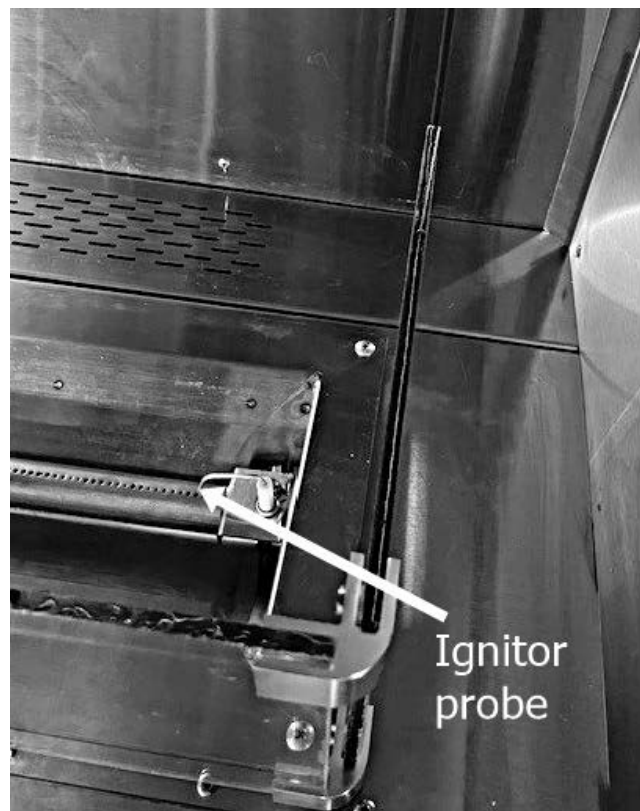

Figure 2

## OPERATING GUIDELINES

**WARNING: CHILDREN AND ADULTS SHOULD BE ALERTED TO THE HAZARDS OF HIGH SURFACE TEMPERATURE AND SHOULD STAY AWAY TO AVOID BURNS OR CLOTHING IGNITION. YOUNG CHILDREN SHOULD BE CAREFULLY SUPERVISED WHEN THEY ARE IN THE SAME ROOM AS THE APPLIANCE.**

**IMPORTANT: TURN OFF GAS BEFORE SERVICING APPLIANCE. IT IS RECOMMENDED THAT A COMPETENT SERVICE TECHNICIAN PERFORM THESE CHECKUPS AT THE BEGINNING OF EACH HEATING SEASON.**

**WARNING: THE FLOW OF COMBUSTION AND VENTILATION AIR MUST NOT BE OBSTRUCTED.**

When lit for the first time, the appliance will emit a slight odor for an hour or two. This is due to paint and lubricants used in the manufacturing process. The main burner flame characteristics are steady, not lifting or floating

## MAINTENANCE INSTRUCTIONS

**IMPORTANT:** THE APPLIANCE AREA MUST BE KEPT CLEAR AND FREE FROM COMBUSTIBLE MATERIALS, GASOLINE AND OTHER FLAMMABLE VAPORS AND LIQUIDS.

Visually inspect the Ignition probe periodically. Brush or blow away any dust or dirt accumulations. probe is dirty, disassembly may be required to remove any foreign material from probe.

Venting system should be periodically examined by a qualified service technician or agency to ensure proper air flow.

## PARTS LIST:

- |                                   |                      |
|-----------------------------------|----------------------|
| 1. Gas Shutoff (page 9)           | OD-LFP-SHUT OFF      |
| 2. Gas ON/OFF Key Valve (page 11) | OD-LFP-KEY VALVE     |
| 3. Glass Wind Guard (page 13)     | OD-LFP-FS            |
| 4. Ignitor (page 14)              | OD-LFP-IGNITOR       |
| 5. Ignitor probe (page 14)        | OD-LFP-IGNITOR PROBE |

## **TWO YEAR LIMITED WARRANTY**

THIS WARRANTY IS LIMITED TO TOP-VENT GAS FIREPLACES MANUFACTURED AND ASSEMBLED BY GOLDEN BLOUNT.

IF GOLDEN BLOUNT FINDS THAT ANY PART OR PORTION OF THE FIREPLACE COVERED BY THIS WARRANTY IS DEFECTIVE IN MATERIAL OR WORKMANSHIP UNDER NORMAL USE AND SERVICE AS DESCRIBED IN THE INSTALLATION AND OPERATING INSTRUCTIONS, GOLDEN BLOUNT WILL TAKE THE FOLLOWING ACTIONS:

1. WITHIN THE FIRST YEAR FROM THE DATE OF INSTALLATION, GOLDEN BLOUNT SHALL, AT ITS OPTION REPLACE OR REPAIR ANY SUCH DEFECT IN MATERIAL OR WORKMANSHIP, AT GOLDEN BLOUNT'S EXPENSE, INCLUDING A REASONABLE LABOR ALLOWANCE AS DETERMINED BY GOLDEN BLOUNT. GOLDEN BLOUNT SHALL NOT BE RESPONSIBLE FOR ANY OTHER LABOR COSTS, OR EXPENSES, INCLUDING INDIRECT, INCIDENTAL OR CONSEQUENTIAL DAMAGES.
2. DURING THE SECOND YEAR AFTER THE DATE OF INSTALLATION, GOLDEN BLOUNT SHALL SUPPLY REPLACEMENT PARTS AT THE CURRENT WHOLESALE PRICE, BUT GOLDEN BLOUNT SHALL NOT BE RESPONSIBLE FOR ANY LABOR, TRANSPORTATION, OR THE INDIRECT, INCIDENTAL, OR CONSEQUENTIAL DAMAGES.
3. ALL FACTORY OPTIONAL COMPONENTS OR ACCESSORIES FOUND TO BE DEFECTIVE WILL BE REPAIRED OR REPLACED WITHOUT CHARGE DURING THE FIRST YEAR AFTER INSTALLATION.

GOLDEN BLOUNT MAY DISCHARGE ITS ENTIRE WARRANTY LIABILITY BY REFUNDING THE PRICE OF THE PRODUCT.

PRODUCTS MADE BY OTHER MANUFACTURERS, SOLD WITH THE FIREPLACE OR THEREAFTER ARE NOT COVERED BY THIS LIMITED WARRANTY. THE USE OF OTHER UNAUTHORIZED COMPONENTS WILL MAKE THIS WARRANTY NULL AND VOID.

THIS LIMITED WARRANTY WILL BE VOID IF THE APPLIANCE IS NOT INSTALLED BY A QUALIFIED INSTALLER AND ACCORDING TO THE INSTALLATION INSTRUCTIONS. THE LIMITED WARRANTY ALSO IS VOID IF THE FIREPLACE IS NOT OPERATED, AT ALL TIMES, ACCORDING TO THE OPERATING INSTRUCTIONS FURNISHED.

SOME STATES DO NOT ALLOW EXCLUSION OF INCIDENTAL OR CONSEQUENTIAL DAMAGES OR LIMITS ON THE DURATION OF IMPLIED WARRANTIES SO THESE LIMITATIONS MAY NOT APPLY TO YOU.

GOLDEN BLOUNT RESERVES THE RIGHT TO INVESTIGATE ANY AND ALL CLAIMS AGAINST THIS WARRANTY AND TO DECIDE ON THE METHOD OF SETTLEMENT.

GOLDEN BLOUNT IS NOT RESPONSIBLE FOR WARRANTY WORK COMPLETED WITHOUT OBTAINING GOLDEN BLOUNT'S CONSENT. GOLDEN BLOUNT EMPLOYEES AND DEALERS HAVE NO RIGHT TO ALTER THIS WRITTEN WARRANTY.

### **WARRANTY INFORMATION**

PLEASE BE ABLE TO PROVIDE THE FOLLOWING INFORMATION WHEN COMMUNICATING WITH GOLDEN BLOUNT OR ITS DEALERS OR DISTRIBUTORS REGARDING SERVICE UNDER THIS WARRANTY.

MODEL NO.  
SERIAL NO.  
DATE OF PURCHASE

Golden Blount, LLC.  
4301 Westgrove Dr.  
Addison, TX. 75001  
(972) 250-3113